



COMMUNITY MEETING

Commission District #1

Betsy VanderLey,
Commissioner

Gelman Land Use Plan

Case Planner:

Steven Thorp
(407) 836-5549
Steven.Thorp@ocfl.net

Tuesday, August 13, 2019 @ 6:00 p.m.

Chain of Lakes Middle School Cafeteria

8700 Conroy Windermere Road, Orlando, Florida 32835

Please join Orange County staff, the applicant and your neighbors for a community meeting to discuss the proposal for the property identified below. The applicant will be present to explain the proposed use and answer questions.

PROJECT INFORMATION

Project Name: Gelman Land Use Plan

Case Number: LUP-19-04-140

Applicant: Jim Hall

Parcel ID: 09-23-28-0000-00-009

Future Land Use: RS 1/1 (Rural Settlement 1/1)

Current Zoning: R-CE (Country Estate District) and R-CE-C (Country Estate Cluster District)

Proposed Zoning: PD (Planned Development District)

Acreage: 18.16 gross acres

Location: 9508 Windy Ridge Road; or generally located on the south side of Windy Ridge Road, approximately 600 feet east of Hempel Avenue

SUBJECT PROPERTY/ LOCATION MAP

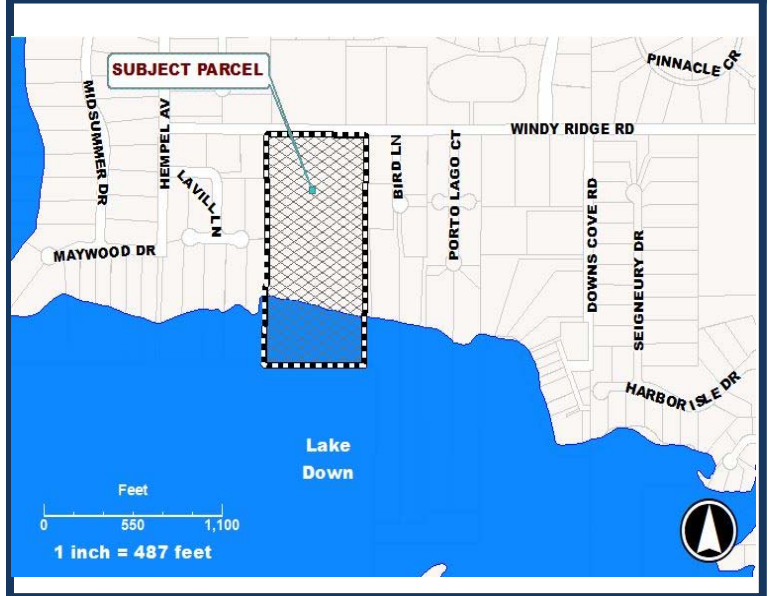

SUMMARY OF REQUEST/ PROPOSED USE

To rezone 18.16 acres from R-CE (Country Estate District) and R-CE-C (Country Estate Cluster District) to PD (Planned Development District), in order to construct 14 single-family residential dwelling units on lots 50 feet wide and 6,000 square feet in area on the eastern portion of the property. The existing single-family home is proposed to remain. Waivers from Orange County Code to reduce required open space, recreation space, & setbacks, and increase impervious surface area are requested.

Please visit our site for more information:
www.OrangeCountyFL.net/Atlas

If you have questions regarding this community meeting please call the Case Planner (listed above)